

SA1-01001NB Installation Guide

SwitchAir 1U Network Switch Cooling

Effective cool air delivery for rear rack mounted 1U switches with side air intakes.

Installation Precaution:

- Install SwitchAir such that the required airflow for safe operation of equipment is not compromised.
- Take precaution to avoid interference with the switch input power cords when installing on a live unit.

SwitchAir 1U Installed in Rack

Installs in minutes while network switch is live.

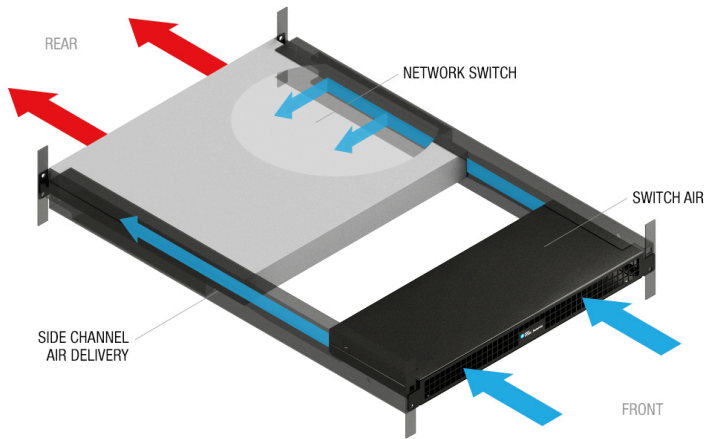

SA1-01001NB Specifications	
Rail Depth Range	27 5/8" to 29 5/8"
Chassis Depth	7"
Channel Length	27 5/8"
Airflow	Passive (Switched Generated)
Switch Intake	Both Sides
Warranty	Lifetime

SA1-01001SS Specifications	
Rail Depth Range	27 5/8" to 29 5/8"
Chassis Depth	7"
Channel Length	27 5/8"
Airflow	Passive (Switched Generated)
Switch Intake	Single Side
Warranty	Lifetime

Installing the SwitchAir

- (1) Before installing SwitchAir, Velcro tie the network switch power cords to power supply handle toward the center of the switch. Place cage nuts in channel mounting holes. Attach Channel to inside of front rail using a single screw at the top cage nut position (rack rail cage nuts and screws not included).

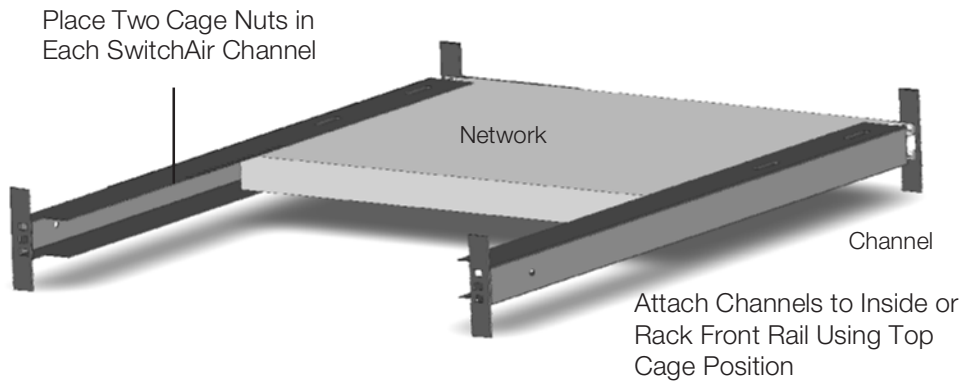

- (2) Before installing SwitchAir; remove the lower network switch mounting screw from each side of the rack front rails. Save these screws to be used in the next step for mounting SwitchAir. The network switch upper screw will remain fastened. Attach Channels to Inside of Rack Front Rail Using Top Cage Position.

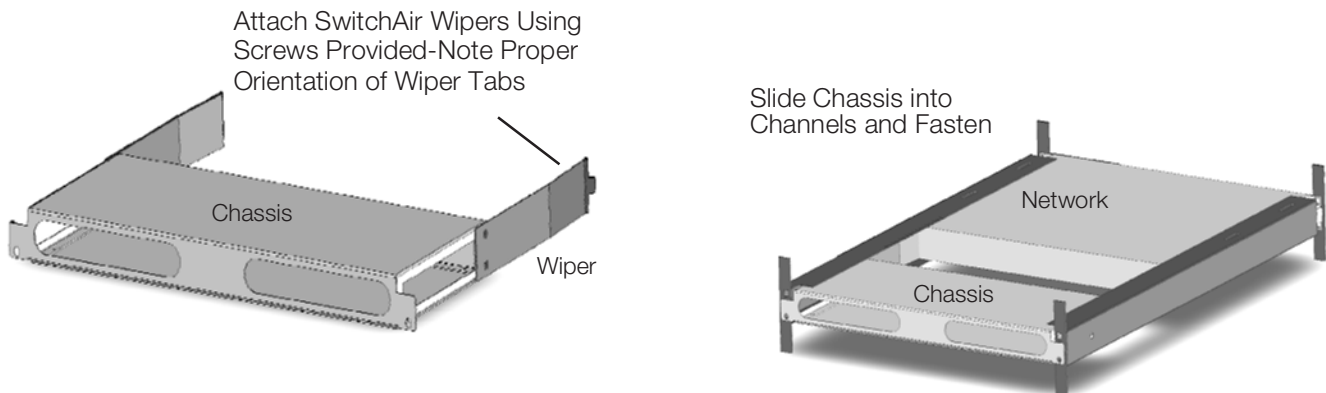

- (3) Slide the SwitchAir Chassis into the SwitchAir Channels from the front of the rack. Attach the SwitchAir Chassis using two screws (not included).